

GCMS-QP2010S



The GCMS-QP2010S gas chromatograph mass spectrometer is based on the high-performance GCMS-QP2010. It combines the benefits of economy, efficiency, stability, and ease of use.

The multi-functional GCMSsolution software incorporates many advanced functions to improve productivity. The FASST (Fast Automated Scan / SIM Type) function, combines the high qualitative performance of Scan with the high sensitivity of SIM. The AART (Automatic Adjustment of Retention Time) function, allows the efficient updating of retention time data.

When used with the broad range of sample preparation and injection devices, techniques such as large volume sample injection, thermal desorption and pyrolysis are possible. The GCMS-QP2010S is suitable for many application fields.

Performance

Mass Range:	m/z 1.5 to 900
Mass Resolution:	R > 2M
Sensitivity (EI)* :	Scan, 1 pg octafluoronaphthalene m/z 272 S/N > 30 (RMS)
	SIM, 100 fg octafluoronaphthalene m/z 272 S/N > 30 (RMS)
Max. Scan Rate:	10,000 u/sec (Single Scan), allows measurement with 0.1 sec scan interval for 0.1u step from m/z 60 to 660 (600u)
Min. Scan Interval:	20 ms (allows max. 50 scans/sec)

Instrument

GC	Model: Shimadzu GC-2010	Column Oven Temp: Up to 450 °C
	Injector Port Temp: Up to 450 °C AFC Pressure Range: 0 to 970kPa	High power oven with fast heat-up rate compatible with fast GC/MS (230VAC)
MS	--- GCMS Interface --- Type: Direct Connection with capillary column Temperature: Up to 350 °C	--- Mass Analyzer and Detector --- Mass Analyzer: Metal quadrupole mass filter with pre-rod Mass Stability: +/- 0.1u /48 hrs (constant temp.) Detector: Electron multiplier with the patented over-drive lens system for noise reduction Dynamic Range: 8 x 10 ⁶ (Electronic)
	--- Ion Source --- Mode: EI Ion Source Temperature: 100 to 260 °C Filament: Dual (Automatic Switching) Electron Energy: 10 to 200 eV Emission Current: 10 to 250 μA Front Access Structure for easy maintenance.	--- Vacuum System --- Main Pump: Turbomolecular pump (65 L/sec for He) Fore-Pump: 30L/min (60Hz) Rotary Pump Column Flow: Up to 2 mL/sec
DI (Option)	Temp. Setting: Room Temp. to 500 °C	Usable without removing the GC column.

Software

GCMSsolution Ver.2.5

Mode: Scan, SIM, FASST(Fast Automated Scan/SIM Type).
 SIM: 64 channels x 128 groups.
 Method Creation: COAST (Creation of Automatic Scan/SIM Table), AART(Automatic Adjustment of Retention Time), Wizard for creation of analysis method and compound table.
 Library Search: Similarity search, Similarity search with retention index, Index search.
 Instrument Tuning: Autotuning for EI mode.
 Mass Spectrum Library (Option): NIST, Wiley, Pesticide Library, FFNSC Library (Flavors and Fragrances), Drug Library, Metabolite Mass Spectral Database.

Option Relating to Application: Method Package (Residual Pesticide in Foods, EPA524, EPA525), Compound Composer, EPA Option Software.
 Various Management Functions: QA/QC function for accuracy management, System Check for Instrument management, Security function for user management.
 File Format: Compound Structure Format best suited for GLP.
 Maintenance Support: MSNAVIGATOR.
 Report: Highly flexible report creation.
 21CFR Compliance: Available in combination with optional software Class Agent.

Installation Example

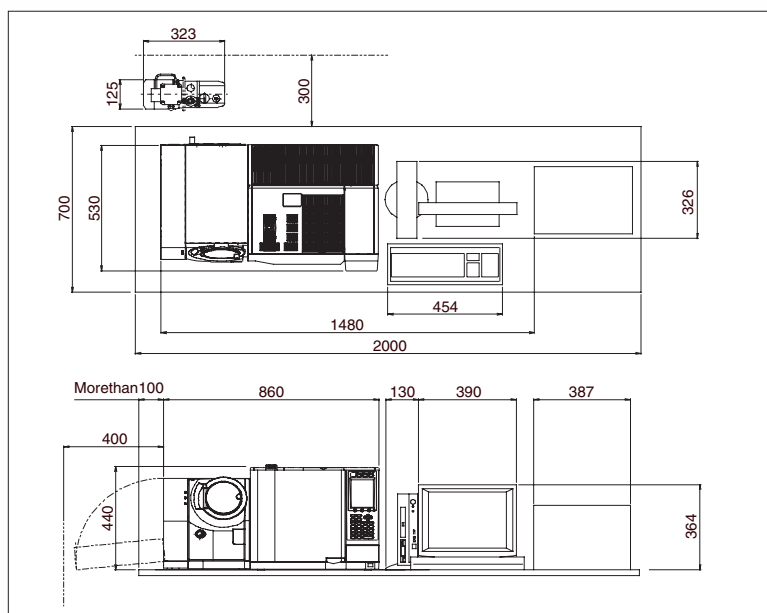

Power Requirements

Frequency: 50/60Hz
 GC: 1800VA (115VAC) / *2600VA(230VAC)
 *High power oven
 MS: 1000VA (100 - 230VAC)

Environment

Temperature: Constant temperature between 18 to 28 °C
 Humidity : 40 to 70 % (No Condensation)

Weight

GC and MS: 68kg
 Rotary Pump: 10kg

Size and weight of PC / Printer vary according to models.

Appearance and Specifications are subject to change without notation for modification.

Founded in 1875, Shimadzu Corporation, a leader in the development of advanced technologies, has a distinguished history of innovation built on the foundation of contributing to society through science and technology. We maintain a global network of sales, service, technical support and applications centers on six continents, and have established long-term relationships with a host of highly trained distributors located in over 100 countries. For information about Shimadzu, and to contact your local office, please visit our Web site at www.shimadzu.com



JQA-0376



SHIMADZU CORPORATION. International Marketing Division

3. Kanda-Nishikicho 1-chome, Chiyoda-ku, Tokyo 101-8448, Japan
 Phone: 81(3)3219-5641 Fax: 81(3)3219-5710

URL <http://www.shimadzu.com>